

ARTISAN

63M (206' 8") | BENETTI | 2019/2022



MULTI-AWARD WINNING BENETTI

At 63m (207ft) with five decks including a top level gym and yoga deck perched high above the sundeck, ARTISAN is one of the largest yachts built by the Benetti shipyard – arguably Italy finest shipyard – with elegant full custom exterior lines drawn by Giorgio Cassetta. She is a highly versatile yacht suitable for families, ocean enthusiasts, and adventurers alike. Truly unique, ARTISAN is likely to turn heads in any harbour you might choose to grace with her presence.

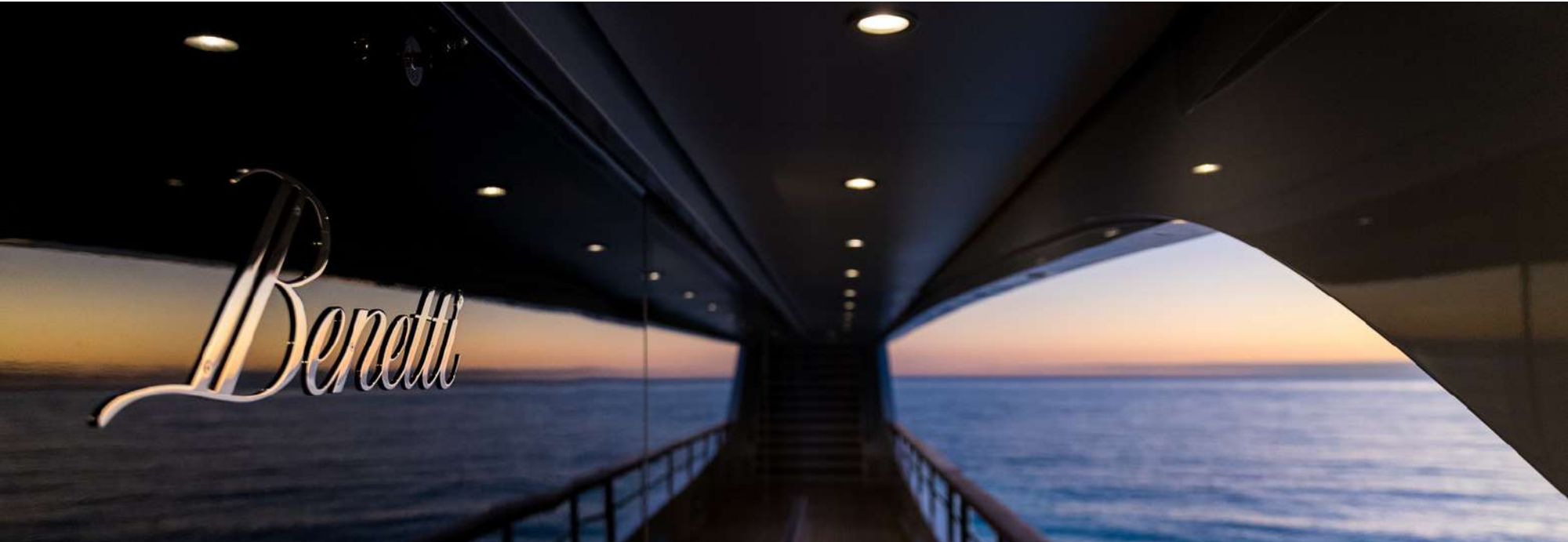



WELCOME ON BOARD

ARTISAN, featuring a steel hull and aluminum superstructure, claims the prestigious title of World Superyacht Awards Winner in 2020 and Best Exterior Design at the World Yacht Trophies in 2019. ARTISAN's glorious outside and inside spaces predominantly showcase carbon, polished steel, and bleached oak, elegantly enhanced with luxurious leather inserts. The bridge deck is 14m-long with a bar and spa pool, spacious sunpads and seating areas. On the upper deck aft, there is a powerful heating system to ensure that the guests can always dine and lounge outside in comfort, at any time of the year.





MAIN DECK AFT SEATING AREA



UPPER DECK AFT DINING AREA





BOW SEATING AREA





BOW LOUNGING AREA





BRIDGE DECK AFT



BRIDGE DECK JACUZZI





BRIDGE DECK BAR



FLY DECK



BEACH CLUB







INTERIORS

Guests are welcomed to an inviting living space tastefully designed by the German studio Birgit Otte Interior and the London-based design firm Bannenberg & Rowell. This unique collaboration resulted in an innovative arrangement of asymmetric interior spaces in which the main saloon, upper saloon and beach club lounge have all been rotated by 30 degrees. This subtle shift delivers a fresh perspective on yachting, offering unique views from every angle. It also imbues the main guest areas on board with a sense of relaxation and elegance.



ELEVATOR



MAIN DECK LOUNGE





MAIN DECK DINING

The interior design palette is soft and contemporary, with iconic Fendi furniture and a bespoke white oak finish offset by carbon fibre and finely crafted details in smoked oak, cream leather and stainless steel. The convivial upper saloon is one of the highlights on board with a dark gloss grand piano and a sculpted American-style bar made of rare white marble and framed in polished steel.



SKY LOUNGE





SKY LOUNGE BAR



ELEVATOR

ACCOMMODATION

The spacious Master suite spans 160 square meters. It features an office and a lounge area, two dressing rooms, two interconnected bathrooms, and a stunning array of forward-facing windows that provide an awe-inspiring 180-degree panoramic view. Additionally, the forward-facing bed offers a captivating panorama, overlooking a generous private bow terrace equipped with seating and sunpads at the forefront.



MASTER SUITE





MASTER BATHROOM



MASTER OFFICE







Among her unique features, ARTISAN boasts a generous convertible VIP cabin on the main deck with a private lounge. It also features an adjoining seventh cabin with small double bed and a balcony for exquisite panoramic ocean views, creating an exclusive retreat for relaxation and entertainment. This cabin can be converted into a massage room.



VIP CABIN





VIP CABIN LOUNGE

GREEK ISLANDS
ST. TROPEZ SOLEIL





On the lower deck, there are four beautifully designed VIP cabins with super-king-sized bed - all with en-suite amenities. The two cabins forward have one pullman berth each.



LOWER DECK VIP CABIN





LIFESTYLE

The shared social and entertainment areas of ARTISAN are equally impressive. Highlights of the yacht include a beach club, a fully-equipped fly deck gym, yoga studio offering spectacular 360° views and children's playroom. ARTISAN is equipped with a wide array of the latest watersports equipment, including 2 x Jetskis, 2 x SeaBobs, and a wealth of other exciting options. In addition, the professional and friendly crew of 15 are ready to welcome guests at any time and organise a varied charter with plenty of entertainment ashore and first-class service on board. A brand new 2023 44 Open Fjord is available for the guests to use.



FLY DECK GYM





MASSAGE ROOM



SEA POOL & WATERTOYS





BRIDGE

SPECIFICATION

CATEGORY:	MOTOR YACHT
LOA:	63.0M (206'7")
BEAM:	10.6M (34'8")
DRAFT:	3.4M (11'2")
BUILDER:	BENETTI
YEAR BUILT:	2019
REFIT:	2022
HULL TYPE:	MONO-HULL
HULL CONFIGURATION:	DISPLACEMENT
HULL MATERIAL:	STEEL
SUPERSTRUCTURE:	ALUMINIUM
EXTERIOR DESIGN:	CASSETTA YACHT DESIGNERS
INTERIOR DESIGN:	BANNENBERG & ROWELL DESIGN
GRT:	1245
CLASS:	LLOYD'S REGISTER
FLAG:	CAYMAN ISLANDS
<hr/>	
GUESTS SLEEPING:	12
GUEST CABINS:	7
GUEST CABIN CONFIGURATION:	1 MASTER, 1 VIP (CONVERTIBLE) WITH ADJOINING DOUBLE CABIN*, 4 LOWER DECK VIP CABINS
BED CONFIGURATION:	6 SUPER KING BEDS, 2 PULLMAN BEDS, 1 SMALL DOUBLE BED
CREW:	CAPTAIN + 14
CREW CABINS:	9
<hr/>	
ENGINES:	2 X 1,810HP MTU 12V4000M53
CRUISING SPEED:	13 KNOTS
MAXIMUM SPEED:	16 KNOTS
RANGE:	3500 NM

*Please note that this cabin can be accessed either through the VIP or the crew quarters, therefore it is recommended for families and staff only.



FEATURED HIGHLIGHTS

- ITALIAN PEDIGREE YACHT WITH AN EXQUISITE DESIGN FROM GIORGIO M. CASSETTA AND INTERIORS STYLED BY BANNENBERG & ROWELL
- AWARDED “WORLD SUPERYACHT 2020” AND “BEST EXTERIOR DESIGN 2019” AT THE WORLD YACHT TROPHIES
- IMPRESSIVE OPEN BEACH CLUB WITH FOLD-DOWN TERRACES
- VAST 160-SQM MASTER SUITE WITH PRIVATE FORWARD DECK, OWNER’S OFFICE AND LOUNGE AREA
- MAIN DECK VIP CABIN INCLUDING A SPACIOUS LOUNGE AND ADJOINING SEVENTH CABIN/MASSAGE ROOM
- FIFTH-LEVEL FULLY EQUIPPED GYM AND YOGA DECK OFFERING SPECTACULAR 360° VIEWS
- ELEVATOR CONNECTING EACH DECK
- CHILD FRIENDLY YACHT WITH LARGE SEA POOL AND TOYS
- BRAND NEW 44 OPEN FJORD CHASE TENDER & EXTENSIVE WATERSPORTS EQUIPMENT

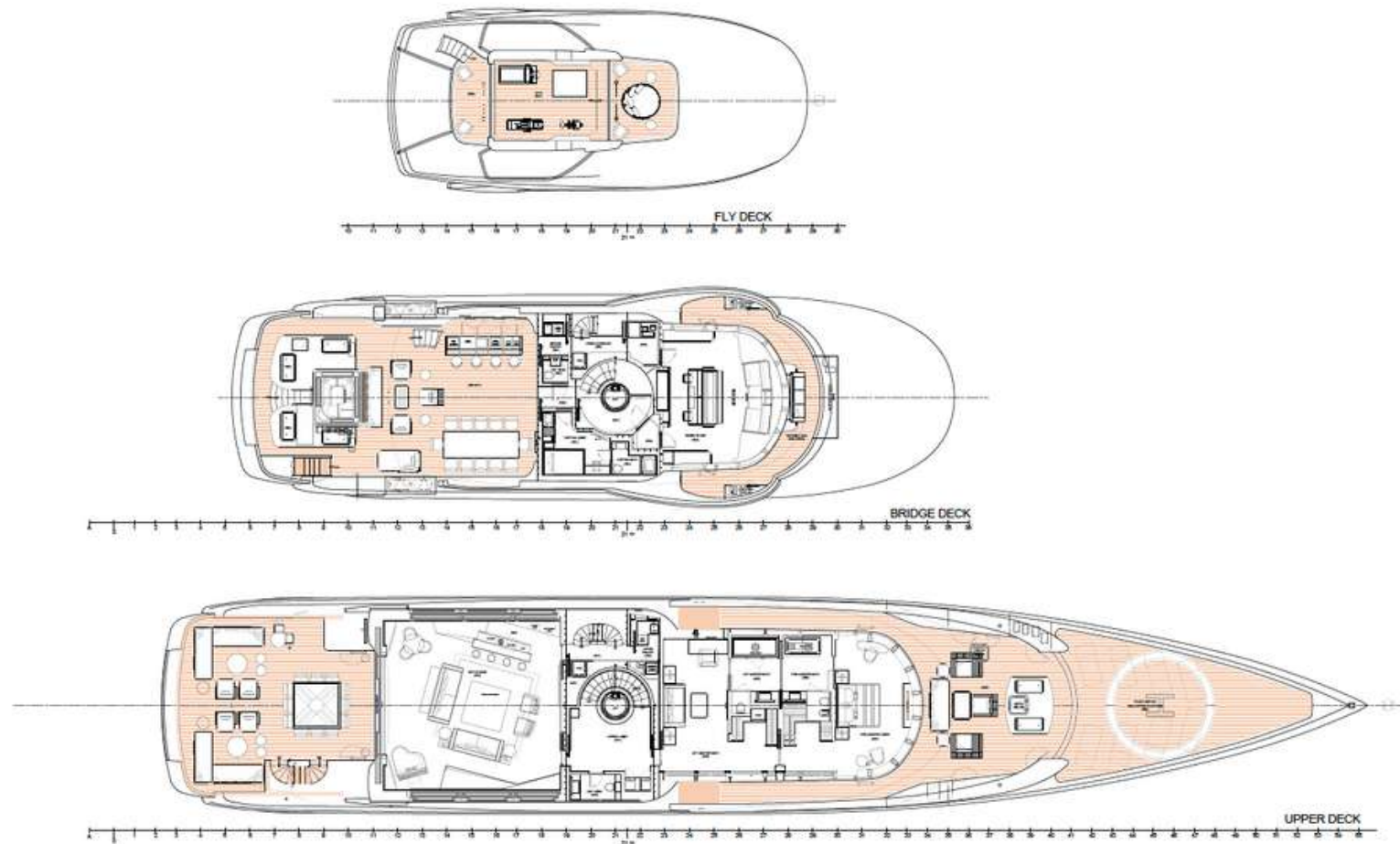

GENERAL ARRANGEMENT

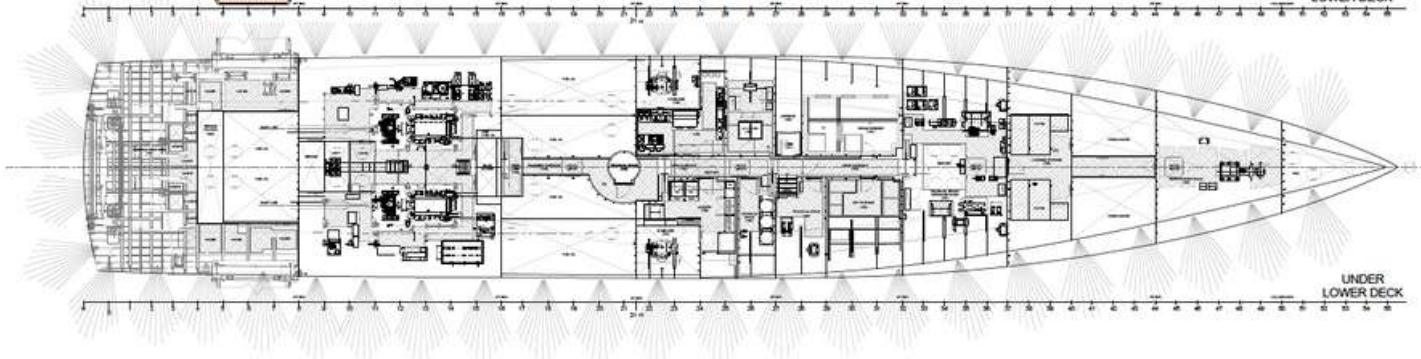
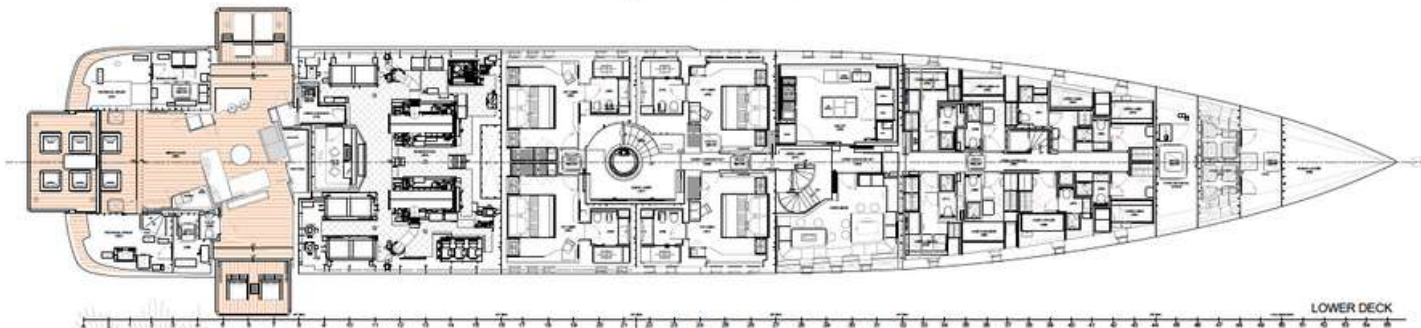
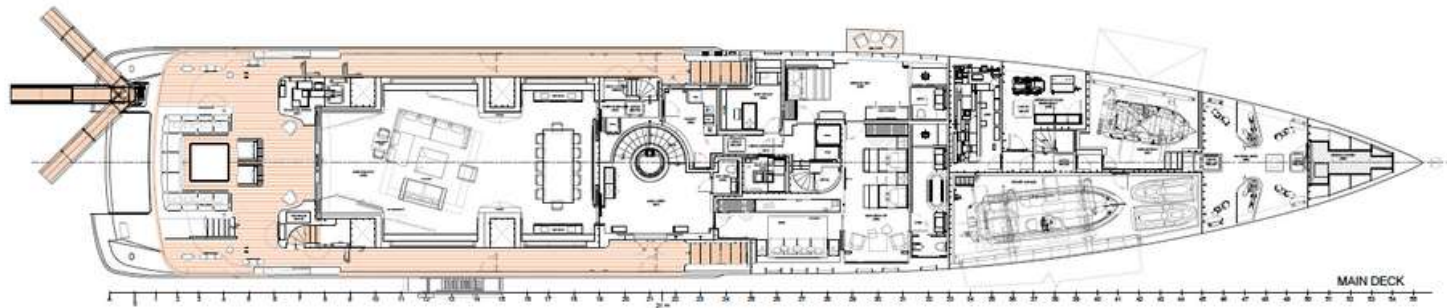

GENERAL ARRANGEMENT







Benetti

